

EWART CHAIN LTD  
GLOBAL SUPPLIER

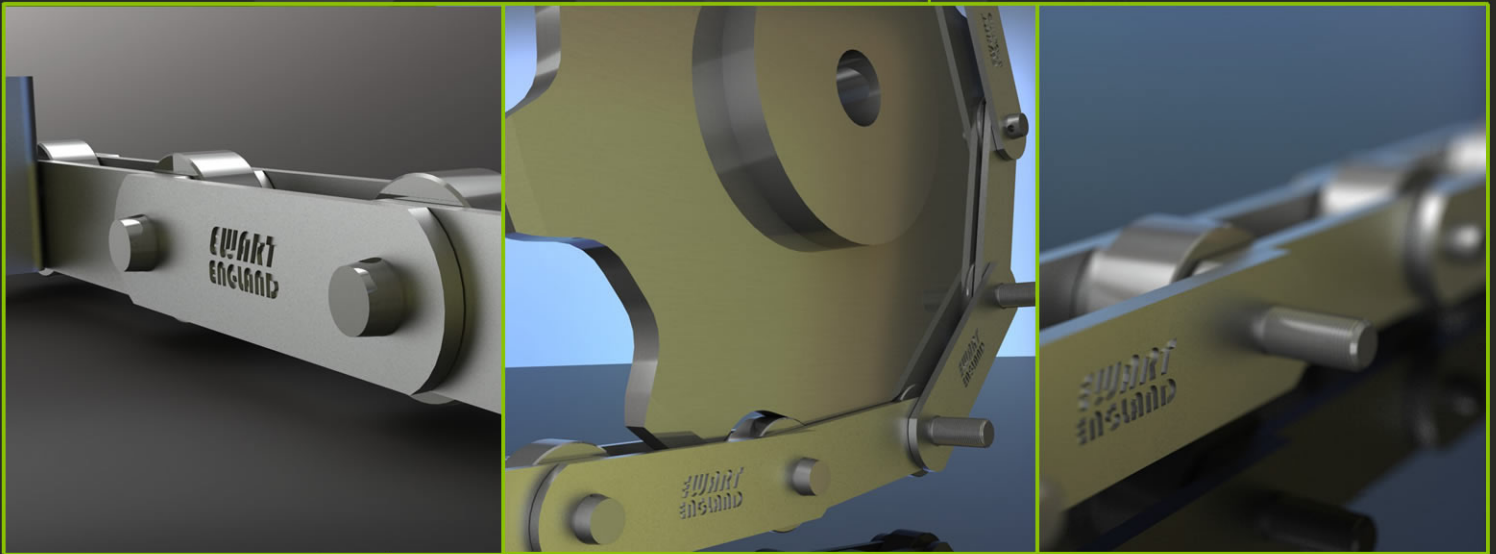

# Palm Oil Industry Chains

EWART CHAIN Ltd est 1880



## Ewart Chain Ltd

THE BEST KNOWN CHAIN BRAND IN THE WORLD





## Ewart GENUINE England



Ewart UK are the **ONLY** manufacturers of the **ORIGINAL** and **GENUINE EWART ENGLAND** chain.



EWART range of palm oil mill chains are designed to meet the needs of our customers providing a suitable choice between heat treatment and materials to suit the individual operating conditions of each mill.

### Ewart GENUINE Range of Palm Oil Chains

Range	Sidebar	Pin	Bush	Roller
<b>ULTIMATE (WRB)</b>	Alloy Steel Hardened & Tempered	Alloy Steel Hardened & Tempered, Further induction Hardened Surface	Alloy Steel Hardened & Tempered	Alloy Steel Hardened & Tempered
<b>X-TREME</b>	Alloy Steel Hardened & Tempered	Alloy Steel Hardened & Tempered, Further induction Hardened Surface	Alloy Steel Case Hardened	Alloy Steel Hardened & Tempered
<b>UNIVERSAL (EUS)</b>	Carbon Steel Hardened & Tempered	Alloy Steel Case Hardened	Alloy Steel Case Hardened	Alloy Steel Case Hardened
<b>UNIVERSAL (EUP)</b>	Alloy Steel Hardened & Tempered	Alloy Steel Case Hardened	Carbon Steel Case Hardened	Alloy Steel Hardened & Tempered
<b>UNIVERSAL (EUX)</b>	Alloy Steel Hardened & Tempered	Alloy Steel Hardened & Tempered, Further Induction Hardened Surface	Carbon Steel Case Hardened	Alloy Steel Hardened & Tempered

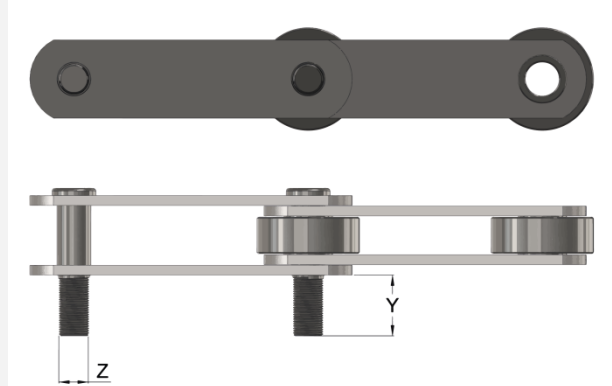
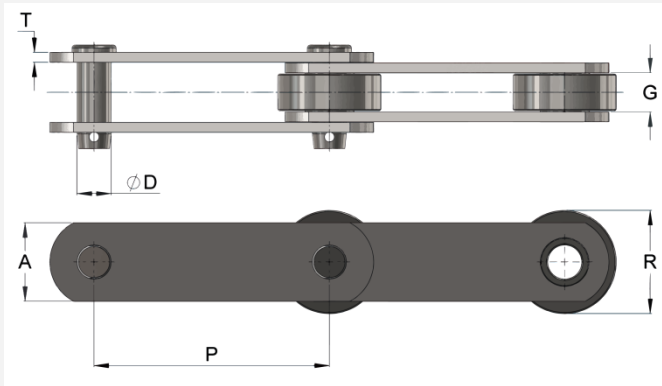

## Ewart GENUINE Range of Palm Oil Mill Chains

### RANGE 1 - ULTIMATE (WRB) Range - (Specification detail on page 1)

Chain Ref	Pitch P	U.T.S Lbs	Pin Dia D	Roller Dia R	S/bar Height A	Dist Between S/bars G	Sidebar Thk T	Extended Screw Pin	
								Y	Z
WRB9503	3.02"	61,500	0.56"	1.18"	1.50"	1.24"	0.25"	-	-
WRB1016H	4.00"	46,000	0.75"	1.87"	1.50"	0.75"	0.25"	1.47"	M16
WRB5289	6.00"	70,000	0.87"	2.63"	2.00"	1.00"	0.25"	1.61"	M20
WRB09060	6.00"	106,000	0.75"	2.75"	2.00"	1.50"	0.375"	1.53"	M18
WRB6889	6.00"	116,000	1.25"	3.50"	2.40"	1.50"	0.35"	1.97"	M30
WRB5305	160mm	95,000	0.69"	2.75"	2.00"	1.50"	0.25"	1.42"	M16

### RANGE 2 - X-TREME Range - (Specification detail on page 1)

SS188	2.609"	25,000	0.50"	No Roller	1.25"	1.06"	0.25"	-	-
9503	3.02"	61,500	0.56"	1.18"	1.50"	1.25"	0.25"	-	-
B3076	3.00"	16,000	0.55"	1.25"	1.00"	0.685"	0.157"	-	-
B4075	4.00"	16,000	0.55"	1.25"	1.00"	0.685"	0.157"	-	-
B5125	4.00"	34,000	0.45"	1.88"	1.25"	0.84"	0.19"	-	-
B5126	4.00"	34,000	0.45"	1.75"	1.13"	1.06"	0.25"	-	-
B1016H	4.00"	46,000	0.75"	1.88"	1.50"	0.75"	0.25"	1.47"	M16
B5326H	6.00"	38,000	0.75"	1.88"	1.50"	0.75"	0.20"	-	-
B5289	6.00"	70,000	0.87"	2.63"	2.00"	1.00"	0.25"	1.61"	M20
09060	6.00"	106,000	0.75"	2.75"	2.00"	1.50"	0.38"	1.53"	M18
B6889	6.00"	116,000	1.25"	3.50"	2.40"	1.50"	0.35"	1.97"	M30
B5305	160mm	95,000	0.69"	2.75"	2.00"	1.50"	0.25"	1.42"	M16
POM4P32	4.000	32,000	0.75"	1.88"	1.50"	0.75"	5mm	1.42"	M16
POM6P40	6.000	40,000	0.75"	1.88"	1.50"	0.75"	6mm	1.47"	M18
POM6P60	6.000	60,000	0.87"	2.63"	2.00"	1.00"	6mm	1.61"	M20
POM6P80	6.000	80,000	0.75"	2.75"	2.00"	1.50"	8mm	1.53"	M18
ES9503S25	3.022	61,500	0.56"	1.18"	1.50"	1.25"	0.25"	-	-
ES4P23	4.00"	38,000	0.75"	1.88"	1.50"	0.75"	0.20"	1.42"	M16
ES90R20	4.00"	39,000	0.45"	1.88"	1.25"	0.84"	0.19"	-	-
ES94R30	4.00"	59,000	0.57"	2.00"	1.50"	1.18"	0.25"	-	-
ES604R30	6.00"	59,000	0.57"	2.00"	1.50"	1.18"	0.25"	-	-
ES6P36	6.00"	82,000	1.06"	2.63"	2.00"	1.00"	0.307"	1.73"	M24
ESB5305R	160mm	95,000	0.69"	2.75"	2.00"	1.50"	0.25"	1.42"	M16

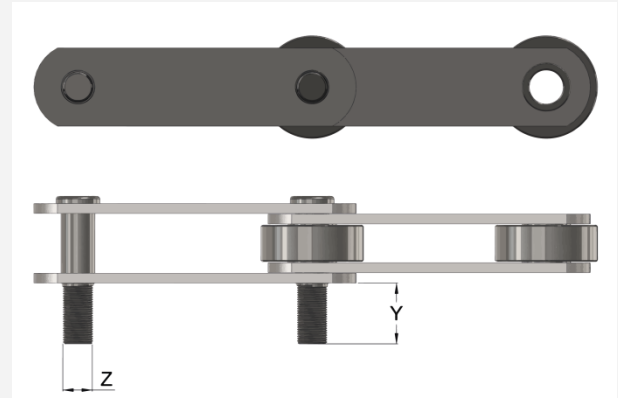
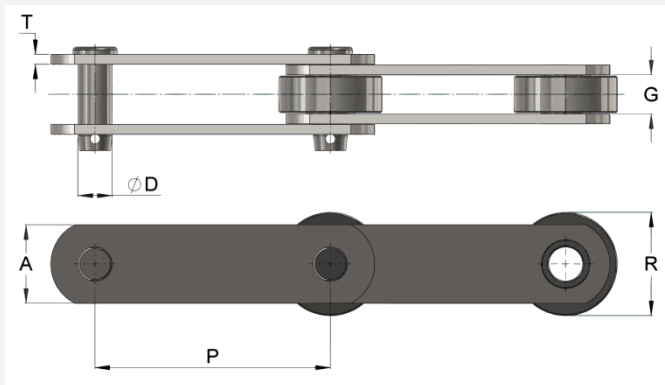

## Ewart GENUINE Range of Palm Oil Mill Chains

### RANGE 3 - UNIVERSAL (EUS) Range - (Specification detail on Page 1)

Chain Ref	Pitch P	U.T.S Lbs	Pin Dia D	Roller Dia R	S/bar Height A	Dist Between S/bars G	Sidebar Thk T	Extended Screw Pin	
								Y	Z
EUS4161	4.00"	18,000	0.75"	1.875"	1.50"	0.75"	4.50mm	1.46"	M18
EUS4162	4.00"	32,000	1.059"	2.625"	2.00"	1.00"	6.40mm	1.57"	M20
EUS6241	6.00"	18,000	0.75"	1.875"	1.50"	0.75"	4.50mm	1.46"	M18
EUS6242	6.00"	32,000	1.059"	2.625"	2.00"	1.00"	6.40mm	1.57"	M20
EUS6243	6.00"	50,000	1.25"	3.500"	2.40"	1.50"	9.00mm	1.97"	M30

### RANGE 3 (Continued) - UNIVERSAL (EUP) Range - (Specification detail on Page 1)

EUP4161	4.00"	26,000	0.75"	1.875"	1.50"	0.75"	4.50mm	1.46"	M18
EUP4162	4.00"	50,000	1.059"	2.625"	2.00"	1.00"	6.40mm	1.57"	M20
EUP6241	6.00"	26,000	0.75"	1.875"	1.50"	0.75"	4.50mm	1.46"	M18
EUP6242	6.00"	50,000	1.059"	2.625"	2.00"	1.00"	6.40mm	1.57"	M20

### RANGE 3 (Continued) - UNIVERSAL (EUX) Range - (Specification detail on Page 1)

EUX4161	4.00"	30,000	0.75"	1.875"	1.50"	0.75"	4.50mm	1.46"	M18
EUX4162	4.00"	60,000	1.059"	2.625"	2.00"	1.00"	6.40mm	1.57"	M20
EUX6241	6.00"	30,000	0.75"	1.875"	1.50"	0.75"	4.50mm	1.46"	M18
EXU6242	6.00"	60,000	1.059"	2.625"	2.00"	1.00"	6.40mm	1.57"	M20

Range 3 UNIVERSAL (EUS) = 4" & 6" pitch chains 18,000 – 50,000 Lbs U.T.S (see page 1 for specification detail)

Range 3 UNIVERSAL (EUP) = 4" & 6" pitch chains 26,000 – 50,000 Lbs U.T.S (see page 1 for specification detail)

Range 3 UNIVERSAL (EUX) = 4" & 6" pitch chains 30,000 – 60,000 Lbs U.T.S (see page 1 for specification detail)

**RANGE 3 – UNIVERSAL = RENOLD EQUIVALENT**

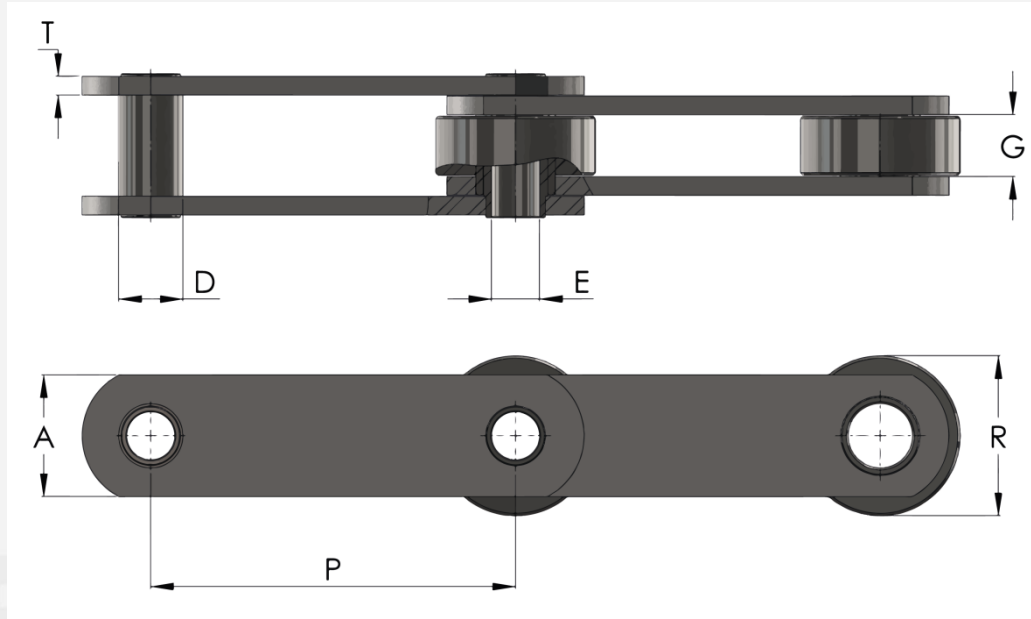

### EWART GENUINE HOLLOW PIN

Chain Ref	Pitch P	U.T.S Lbs	Pin O/D D	Pin E	Roller Dia R	S/bar Height A	Dist Between G	Thk T
B5127	4.00"	12,000	0.75"	0.52" Bore	1.88"	1.50"	0.75"	0.20"
HES4P18	4.00"	18,000	0.75"	0.52" Bore	1.88"	1.50"	0.75"	0.20"
B5130	4.00"	36,000	1.06"	0.79" Bore	2.625"	2.00"	1.00"	0.25"
B5325	6.00"	30,000	1.06"	0.79" Bore	2.625"	2.00"	1.00"	0.25"
B5328	6.00"	35,000	1.06"	0.79" Bore	2.625"	2.00"	1.00"	0.25"
HES6P30	6.00"	38,000	1.06"	0.79" Bore	2.625"	2.00"	1.00"	0.28"
B5327	6.00"	50,000	1.06"	0.79" Bore	2.625"	2.00"	1.00"	0.315"

#### RANGE 3 - UNIVERSAL (EUHS) Hollow Pin - (Specification detail on page 1)

EUHS4161	4.00"	15,000	0.75"	0.52"	1.875"	1.50"	0.75"	4.50mm
EUHS4162	4.00"	26,000	1.059"	0.79"	2.625"	2.00"	1.00"	6.40mm
EUHS6242	6.00"	26,000	1.059"	0.79"	2.625"	2.00"	1.00"	6.40mm
EUHS6243	6.00"	44,000	1.25"	0.91"	3.500"	2.40"	1.50"	9.00mm

#### RANGE 3 (Continued) - UNIVERSAL (EUHP) Hollow Pin - (Specification detail on page 1)

EUHP4161	4.00"	17,000	0.75"	0.52"	1.875"	1.50"	0.75"	4.50mm
EUHP4162	4.00"	36,000	1.059"	0.79"	2.625"	2.00"	1.00"	6.40mm
EUHP6242	6.00"	36,000	1.059"	0.79"	2.625"	2.00"	1.00"	6.40mm

#### RANGE 3 (Continued) - UNIVERSAL (EUHX) Hollow Pin - (Specification detail on page 1)

EUHX4161	4.00"	24,000	0.75"	0.52"	1.875"	1.50"	0.75"	4.50mm
EUHX6242	6.00"	50,000	1.059"	0.79"	2.625"	2.00"	1.00"	6.40mm

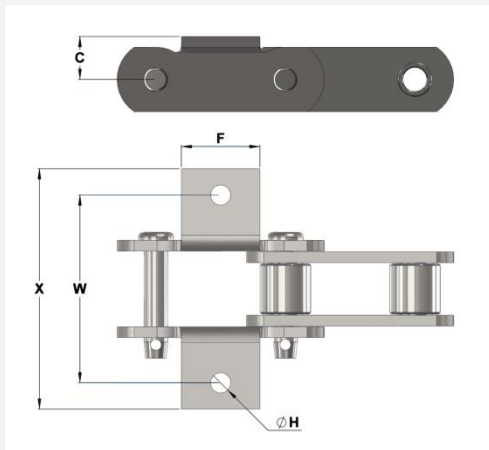

K1 Attachments

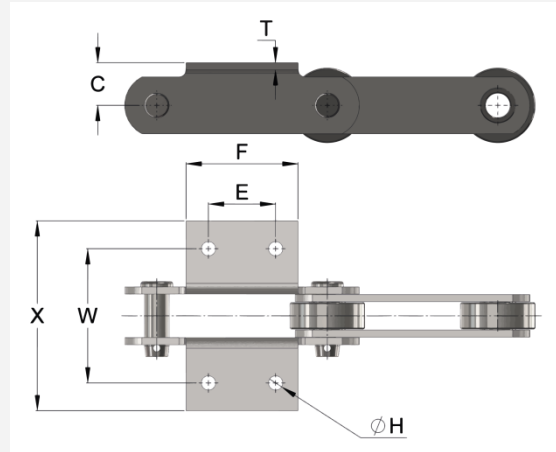

K2 Attachments

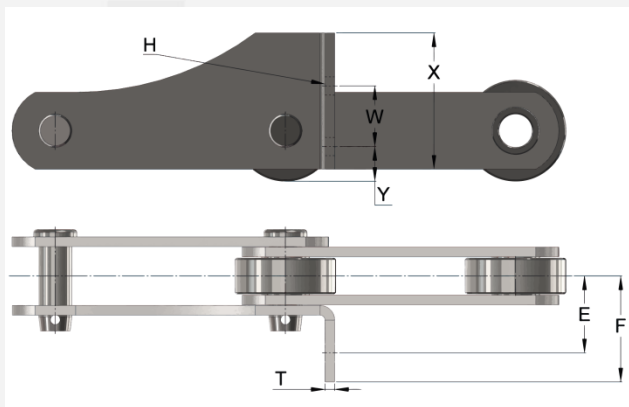

LA 2 Attachments

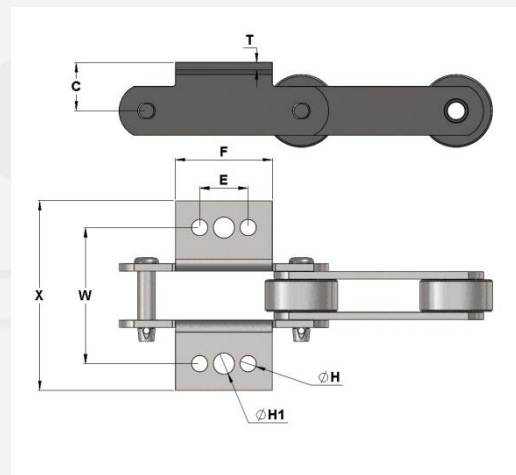

K3 Attachments

### K1 Attachments

Chain Ref	C	F	H	T	W	X
WRB9503, 9503, ES9503S25	1.00"	1.81"	0.47"	0.25"	4.38"	5.63"

### K2 Attachments

Chain Ref	C	E	F	H	T	W	X
WRB5289, B5289	1.50"	60MM	100MM	0.50"	0.25"	120MM	170MM
WRBB1016H, B1016H, ES94R30	1.25"	1.25"	2.81"	0.42"	0.25"	3.50"	5.50"
ES4P23	1.25"	1.25"	2.81"	0.42"	0.20"	3.50"	5.50"

### K3 Attachments

Chain Ref	C	E	F	H	H1	T	W	X
ES90R20	1.25"	1.25"	2.5"	0.42"	0.55"	4.8MM	3.5"	4.87"

### LA 2 Attachments

Chain Ref	C	E	F	W	X	H	T
WRB5289, B5289	2.00"	2.75"	0.47"	0.25"	40MM	3.50"	0.90"
ES90R20	2.00"	2.75"	0.47"	4.8MM	40MM	2.75"	0.91"

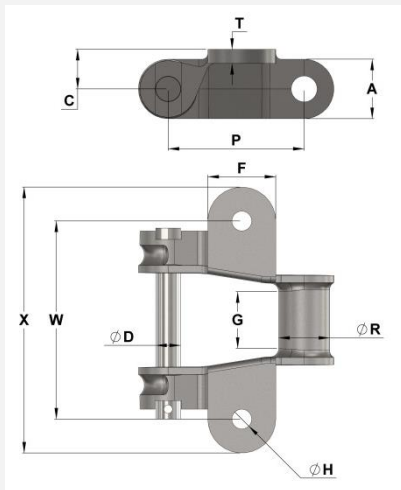

K1 Attachment

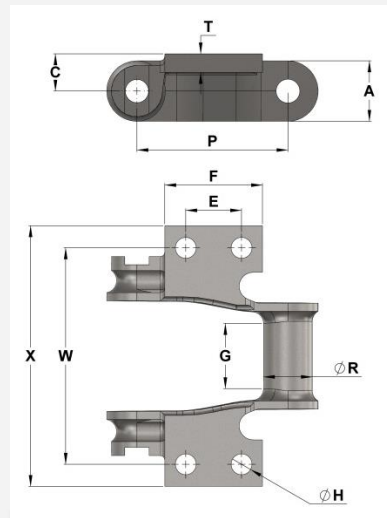

K2 Attachment

### Cast Elevator Chains

Chain Ref	Pitch P	U.T.S Lbs	Pin Dia D	S/bar Height A	Max Gearing G	Barrel Dia R	C	E	F	Bolt Dia H	T	W	X
503 K1	3.020"	20,000	0.56"	1.38"	1.13"	1.09"	0.88"	-	1.63"	0.38"	0.31"	4.38"	5.63"
504 K2	4.060"	27,500	0.63"	1.69"	1.75"	1.31"	1.00"	1.50"	2.63"	0.50"	0.50"	5.81"	7.00"

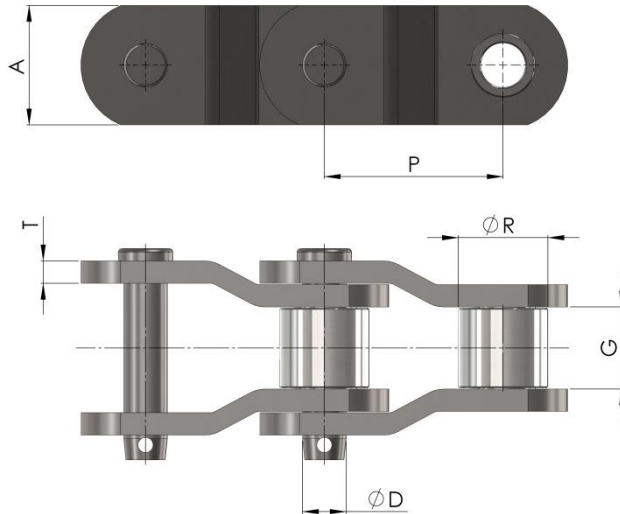

### Heavy Duty Steel Rotary Drive Chains

Chain Ref	Pitch P	U.T.S	Pin Dia D	Roller Dia R	S/bar Height A	Max Gearing G	T
API3P	3.075"	75,000	0.65"	1.25"	1.56"	1.50"	0.38"
B7811	3.075"	100,000	0.65"	1.25"	1.75"	1.50"	0.38"
API4P	4.063"	150,000	0.88"	1.75"	2.25"	2.00"	0.50"

The tabular dimensions are approximate and are not binding. Design improvements may result in variation from the published figures and verification is recommended. Renold equivalent is for guide line only.



## Ewart Chain

EWART CHAIN LTD

Colombo Street  
Derby  
DE23 8LX  
England  
UK

CALL: +44 (0)1332 345451  
EMAIL: [sales@ewartchain.co.uk](mailto:sales@ewartchain.co.uk)  
WEB: [www.ewartchain.co.uk](http://www.ewartchain.co.uk)